



ESOTERIC ESTATES

PUTTING YOUR HOME IN THE BEST LIGHT

1 Bedroom Flat for Rent - **£675 per month**

Austen Court, Netley Abbey, Southampton, SO31 5HR



KEY FEATURES

- Refurbished One Bed Ground Floor Flat
- Light & Airy
- Newly Installed Kitchen & Utilities
- Security Entry System
- Allocated Parking
- Available Immediately
- Minimum 12 Month Tenancy
- No Pets, Smokers or DSS

Description

Esoteric Estates are please to be offering for rent this light and airy refurbished one bedroom ground floor flat that benefits from high ceilings and allocated parking. The property is very close to the train station and bus stop, and a short walk from local shops and amenities.



GROUND FLOOR
621 sq.ft. (57.7 sq.m.) approx.

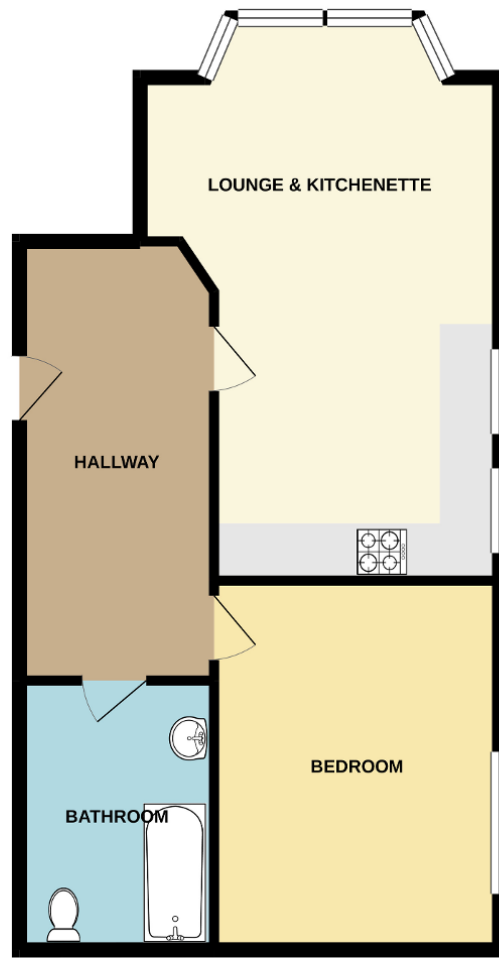

TOTAL FLOOR AREA : 621 sq.ft. (57.7 sq.m.) approx.

Whilst every attempt has been made to ensure the accuracy of the floorplan contained here, measurements of doors, windows, rooms and any other items are approximate and no responsibility is taken for any error, omission or mis-statement. This plan is for illustrative purposes only and should be used as such by any prospective purchaser. The services, systems and appliances shown have not been tested and no guarantee as to their operability or efficiency can be given.
Made with Metropix ©2020

Additional Information

£150 (one week's rent) holding fee. Total deposit to be held by DPS is £750 (5 weeks rent)
Council Tax Band: A

Energy Efficiency

